

SELLING & RENTING  
HOMES  
— Since 2005 —



LAND ESTATES  
SALES, LETTINGS & MANAGEMENT



## WEST HILL DARTFORD

LEASEHOLD  
**£190,000**

- One bedroom apartment.
- Top floor apartment - Accessible via lift.
- Lease length - 114 years remaining.
- Ground rent - £100 per annum.
- Chain free.
- Walking distance to Dartford Train Station and Town Centre.
- Service charge - £1500 per annum.

Chain free!

Land Estates are delighted to bring to the market this spacious, one bedroom apartment in Dartford.

This property has been kept to a great standard and has the added benefit of being located on the top floor.

The apartment comprises of an entrance hall, a lounge, a kitchen, a bathroom and large double bedroom.

Both the bedroom and lounge have access to a Juliet balcony.

Cliffside Court is in a great location, it is within walking distance to Dartford Train Station and Dartford Town Centre.

Lease length - 114 years remaining.

Service charge - £1500 per annum.

Ground rent - £100 per annum.

Please contact Land Estates to arrange a viewing.





# Cliffside Court, Dartford, DA1

Approximate Gross Internal Area 44.6 sq m / 481 sq ft

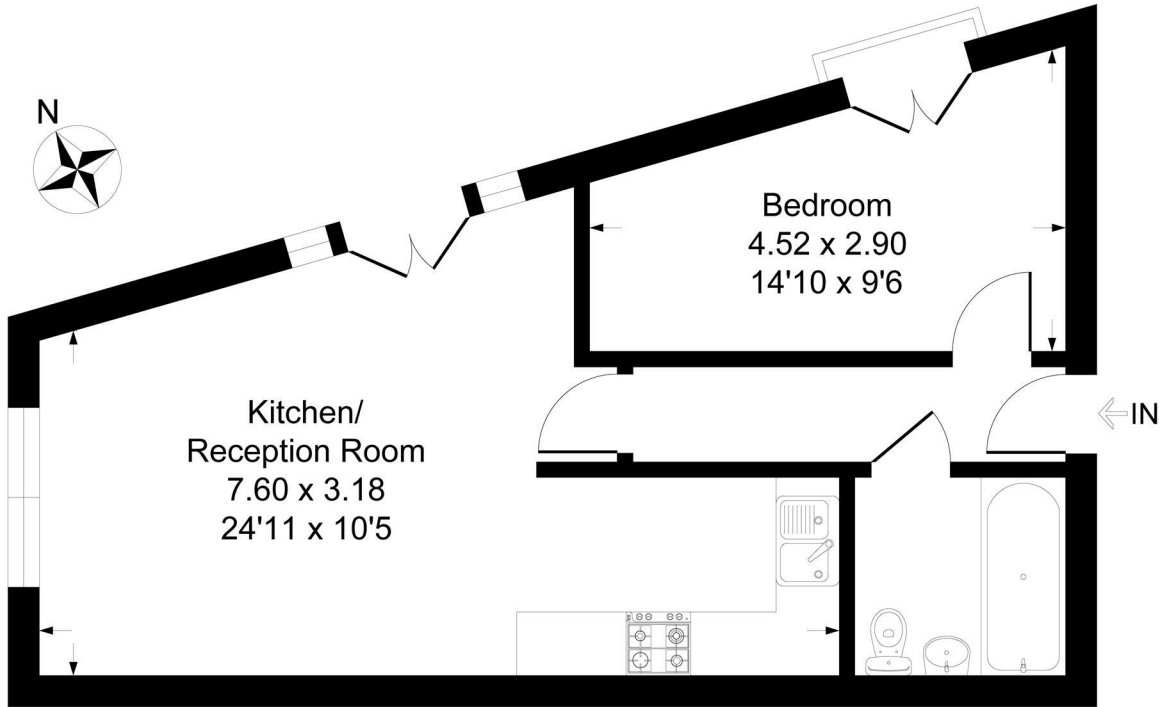

## Fourth Floor



This plan is for layout guidance only. Not drawn to scale unless stated. Windows and door openings are approximate. Whilst every care is taken in the preparation of this plan, please check all dimensions, shapes and compass bearings before making any decisions reliant upon them.  
Produced By Planpix



Energy Efficiency Rating		
	Current	Potential
Very energy efficient - lower running costs		
(92 plus) <b>A</b>		
(81-91) <b>B</b>		
(69-80) <b>C</b>	<b>78</b>	<b>79</b>
(55-68) <b>D</b>		
(39-54) <b>E</b>		
(21-38) <b>F</b>		
(1-20) <b>G</b>		
Not energy efficient - higher running costs		
<b>England &amp; Wales</b>	EU Directive 2002/91/EC	

**EPC Rating: C    Council Tax Band: B**

Agents Note: Whilst every care has been taken to prepare these particulars, they are for guidance purposes only. All measurements are approximate and are for general guidance purposes only and whilst every care has been taken to ensure their accuracy, they should not be relied upon and potential buyers/tenants are advised to recheck the measurements

Land Estate  
6 Market Street  
Dartford  
Kent  
DA1 1ET

01322 413501  
info@landestate.co.uk  
www.landestate.co.uk



**LAND ESTATES**  
SALES, LETTINGS & MANAGEMENT